



# PulsaJet® 10000

**Automatic Spray Gun** designed for accurate spray placement and spray pattern integrity in high-speed or low capacity applications.

## Specifications

Electronically-activated hydraulic atomizing valve

Cycle duration from 6 milliseconds to continuous spray

High-flow version accepts standard UniJet® tip sizes from -015 to -03 capacity

[Request Catalog 60B for UniJet spray tip specifications.](#)

Low-flow version accepts standard UniJet® tip sizes up to -01 capacity

[Request Catalog 60B for UniJet spray tip specifications.](#)

Mounting on the front, sides or back with #8-32 UNC threaded screws

Includes 13' of polyurethane-jacketed cables; 3-pole, female M8 threaded style; thread is constructed of nickel-plated brass

Wetted parts are constructed of stainless steel, Ryton® or Peek for maximum chemical resistance; seals are Viton®

Power: 24VDC actuation, .36 AMP

Inlet connection: 1/8" NPT or BSPT

Maximum pressure: 100 psi (7 bar)

Maximum fluid operating temperature: 200°F (94°C)

Weight: 9 oz. (.26 kg)

## Benefits

- Fast on-off operation (**pulse width modulation**) accurately controls flow rate while maintaining spray pattern integrity

Pulse width modulation is the fundamental principle that allows a significant reduction in flow by regulating the on/off time that the valve operates. Short pulses of on-time and longer pulses of off-time produce a spray pattern that appears continuous but actually reduces the overall flow delivered to the target surface.

- Provides unlimited flexibility in the design of high-speed, low-capacity spray applications
- Compact, lightweight design
- High- and low-flow versions provide a wide range of spray capacities
- All wear parts are easily accessible from the front for minimum maintenance downtime
- Optional mounting assembly available

[Request data sheet 50935 for more information.](#)

## Typical Applications



Coating



Sealing



Marking

Moisturizing  
Lubricating  
Robotics



## PulsaJet 10000 and the Model 2250 AutoJet® Spray Controller

When paired with our Model 2250 AutoJet Spray Controller, the PulsaJet 10000 is capable of operating at extremely high speeds up to 10,000 cycles per minute. The Model 2250 Controller provides much faster response times than comparable PLCs, which is critical for very precise conveyor belt spraying and for tight control of the anticipator/follower feature of automatic spray guns.

### Descriptions

Side View

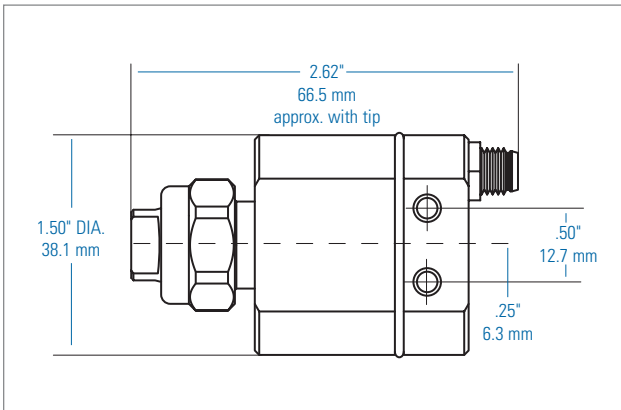

Front

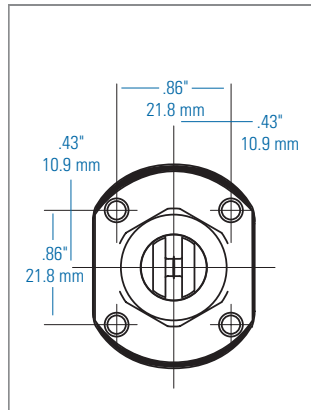

Back

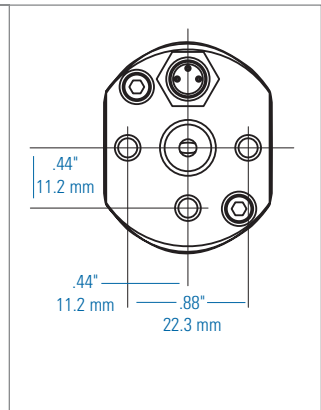

### Ordering Information

<b>High Flow</b>	<b>High Flow Metric</b>
AA10000AUH-H   SPRAY GUN      HIGH FLOW	AAB10000AUH-H                        BSPT SPRAY GUN      HIGH FLOW
<b>Low Flow</b>	<b>Low Flow Metric</b>
AA10000AUH-L   SPRAY GUN      LOW FLOW	AAB10000AUH-L                        BSPT SPRAY GUN      LOW FLOW



**Spraying Systems Co.**  
Experts in Spray Technology



Spray Nozzles



Spray Control



Spray Analysis



Spray Fabrication

P.O. Box 7900, Wheaton, IL 60189-7900 USA

Tel: 1.800.95.SPRAY    Intl. Tel: 1.630.665.5000

Fax: 1.888.95.SPRAY    Intl. Fax: 1.630.260.0842

www.spray.com

